

REV	DESCRIPTION	DATE
△	RDK-97048	張馨尹 2008/06/02
△	RDK-97127	張馨尹 2008/11/14
△	RDK-98020	張馨尹 2009/12/15

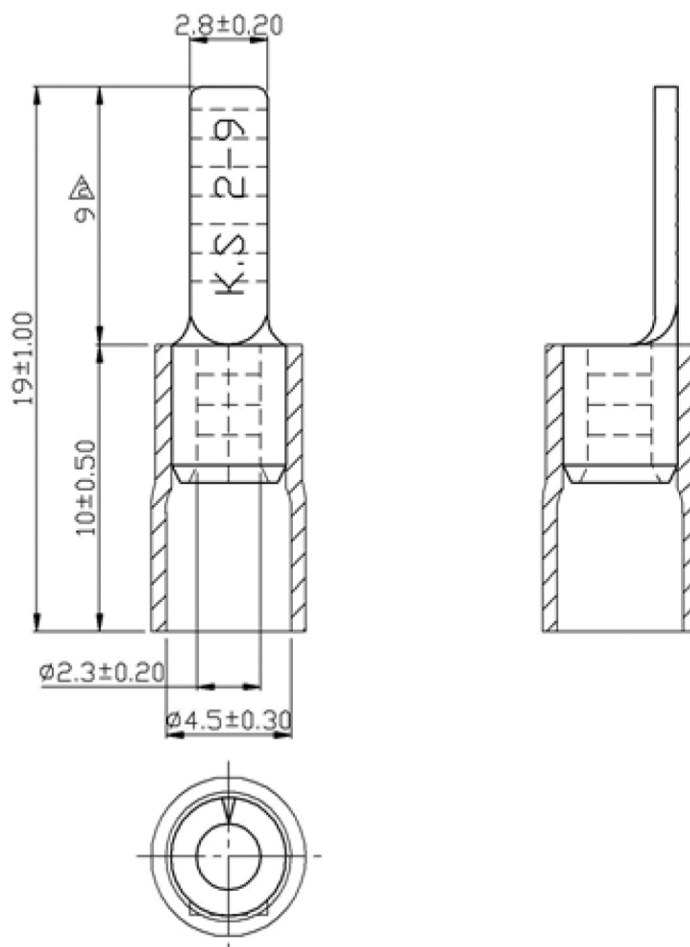

NOTE:

1. MAXIMUM ELECTRIC CURRENT : 

A.W.G.	16	14	
AMP.	18	30	
2. MAXIMUM ELECTRICAL RATING : △ 105°C 600 VOLTS MAX.
3. INSULATION MATERIAL : VINYL
4. INSULATION COLOR : BLUE
5. TERMINAL MATERIAL : COPPER
6. WIRE RANGE : 16-14 A.W.G.( 1.5-2.5 mm<sup>2</sup>)
7. TERMINAL SURFACE TREATMENT : TIN PLATED
8. TERMINAL THICKNESS : 0.80 mm

△ Tolerance Unless Otherwise Specified	
0 >	mm ±
>	mm ±
>	mm ±
>	mm ±
	ANGLE
	° REF ±
	° ±
	° ±

NAME	VINYL-INSULATED BLADE TERMINALS			UNIT	mm
PART NO.	VBL2-9-28	MATERIAL	-----	APPROVE	
NUMBER	KA-951160-C	SCALE	SHEET	PAGE	CHECKED
DATE	2006/08/22	4/1	1-3	10F2	DRAWN 張馨尹